



Built on Brownfield Sites

The establishment of Manipal Jaipur University on brownfield sites represents a progressive strategy that yields advantages for both the institution and the adjacent communities. This initiative reflects a dedication to sustainable land utilization, environmental stewardship, and urban revitalization. By focusing on the long-term advantages of rejuvenated areas, economic development, and ecological enhancement, sustainability emerges as a compelling option for universities aiming to positively influence their environments. Through this initiative, Manipal Jaipur University has the potential to invigorate educational opportunities and aid in the restoration of underutilized spaces.

Utilizing brownfield sites fosters sustainable land management by transforming previously disturbed or contaminated areas rather than encroaching upon untouched green spaces. This strategy aligns Manipal Jaipur University with international efforts to safeguard natural ecosystems. The university's presence on brownfield sites acts as a catalyst for urban renewal, stimulating investment in essential infrastructure and amenities, including public transport, parks, and housing. The redevelopment of these sites facilitates the cleanup and rehabilitation of polluted land, thereby enhancing environmental quality and mitigating public health risks. Furthermore, Manipal Jaipur University actively engages with local communities to address concerns related to land use changes, increased traffic, and the potential displacement of residents.

Manipal Jaipur University is committed to investing in the requisite infrastructure, such as roads, utilities, and public services, to support the new campus and its surrounding environment.

Sr. no.	Facility	Count
1	Total Area of MUJ	122 Acre
2	Available Free Land	33 Acre
3	Administrative Block	1
4	Academic Blocks	3
5	Food Court	1
6	Classrooms	198
7	Laboratories	128
8	Auditorium	3
9	Under Pass/SubWay	1
10	Boardroom	17
11	Seminar Hall/Design studio/Activity halls	17



PICTURE 1: Brown land before construction of MUJ



PICTURE 2: Construction of MUJ



PICTURE 3: Pantation after construction



PICTURE 4: lush green MUJ campus



Manipal Jaipur University Built on Brownfield Sites

Building Manipal Jaipur University on brownfield sites is a forward-thinking approach that benefits both the institutions and its surrounding communities. Manipal Jaipur University demonstrates a commitment to sustainable land use, environmental responsibility, and urban renewal. Keeping in mind the long-term benefits of revitalized areas, economic growth, and environmental improvement make sustainability an attractive choice for university seeking to make a positive impact on its surroundings. By embracing the opportunities, Manipal Jaipur University can truly breathe new life into education and contribute to the rejuvenation of neglected spaces.

Building on brownfield sites promotes sustainable land use by redeveloping previously disturbed or polluted areas instead of encroaching on pristine green spaces. This approach aligned Manipal Jaipur University with global efforts to preserve natural ecosystems. Manipal Jaipur University being built on brownfield sites serves as anchors for urban revitalization, encouraging investment in infrastructure and amenities, such as public transportation, parks, and housing. Redeveloping brownfield sites allows for the cleanup and remediation of contaminated land, improving overall environmental quality and reducing risks to public health. Manipal Jaipur University is engaging with local communities which is crucial to address concerns about land use changes, increased traffic, and potential displacement of residents.

Manipal Jaipur University invests in the necessary infrastructure, such as roads, utilities, and public services, to support the new campus and its surrounding area.

Sr. no.	Facility	Count
1	Total Area of MUJ	122 Acre
2	Available Free Land	33 Acre
3	Administrative Block	1
4	Academic Blocks	3
5	Food Court	1
6	Classrooms	198
7	Laboratories	128
8	Auditorium	3
9	Under Pass/SubWay	1



10	(University under Section 2(f) of the UGC Act) Boardroom	17
11	Seminar Hall/Design studio/Activity halls	17



PICTURE 1: Brown land before construction of MUJ



PICTURE 2: Construction of MUJ



PICTURE 3: Pantation after construction



PICTURE 4: lush green MUJ campus



Head Office HBC

Rajasthan State Pollution Control Board
4, Institutional Area, Jhalana Doongari, Jaipur-302 004

Phone: 0141-2716840



Registered

File No : F(HDF)/JAIPUR(Sanganer)/6935(1)/2023-2024/5986-5988

Order No : 2023-2024/HBC/2809

Dispatch Date: Dec 14 2023 1:06PM

Unit Id : 27890

M/s Manipal University, Jaipur

Khasra No 467,469,474,458/1,473,475, 542, 544

Village Dehmi Kalan, Tehsil Sanganer, Ajmer Road ,

Dehmi Kalan Tehsil:Sanganer

District:JAIPUR

Sub: Consent to Establish under Section 25/26 of the Water (Prevention & Control of Pollution) Act, 1974 and under Section 21(4) of Air (Prevention & Control of Pollution) Act, 1981.

Ref: Your application(s) for Consent to Establish dated 16/06/2023 and subsequent correspondence.

Sir,

Consent to Establish under the provisions of Section 25/26 of the Water (Prevention & Control of Pollution) Act, 1974 (hereinafter to be referred as the Water Act) and under Section 21 of the Air (Prevention & Control of Pollution) Act, 1981, (hereinafter to be referred as the Air Act) as amended to date and rules & the orders issued thereunder **is hereby granted** for your **Manipal University Jaipur plant** situated / proposed at **Khasra No 467,469,474,458/1,473,475, 542, 544 village Dehmi Dehmi Kalan Tehsil:Sanganer District:JAIPUR** , Rajasthan under the provisions of the said Act(s). This consent is granted on the basis of examination of the information furnished by you in consent application(s) and the documents submitted therewith, subject to the following conditions:-

- 1 That this Consent to Establish is valid for a period from **16/06/2023 to 31/05/2028 or date of commencement of production / commissioning of the project or activities whichever is earlier .**
- 2 That this Consent is granted for manufacturing / producing following products / by products or carrying out the following activities or operation/processes or providing following services with capacities given below:

Particular	Type	Quantity / Capacity
Gross Built up Area	Product	21,525.00 SQ. METER

- 3 That in case of any increase in capacity or addition / modification / alteration or change in product mix or process or raw material or fuel, the project proponent is required to obtain fresh consent to establish.





Head Office HBC
Rajasthan State Pollution Control Board
4, Institutional Area, Jhalana Doongari, Jaipur-302 004
Phone: 0141-2716840

Registered

File No : F(HDF)/JAIPUR(Sanganer)/6935(1)/2023-2024/5986-5988

Order No : 2023-2024/HBC/2809

Dispatch Date: Dec 14 2023 1:06PM

Unit Id : 27890

- 4 That the control equipment as proposed by the applicant shall be installed before trial operation is started for which prior consent to operate under the provision of the **Water Act and Air Act** shall be obtained. This consent to establish shall not be treated as consent to operate.
- 5 That the quantity of effluent generation and disposal along with mode of disposal for the treated effluent shall be as under:

Type of effluent	Max. effluent generation (KLD)	Quantity of effluent to be recycled (KLD)	Quantity of treated effluent to be disposed (KLD) and mode of disposal
Domestic Sewage	24.000	16.000	5.000 Plantation and Horticulture within premises

- 6 That the sources of air emissions along with pollution control measures and the emission standards for the prescribed parameters shall be as under:





Head Office HBC
Rajasthan State Pollution Control Board
4, Institutional Area, Jhalana Doongari, Jaipur-302 004
Phone: 0141-2716840

Registered

File No : F(HDF)/JAIPUR(Sanganer)/6935(1)/2023-2024/5986-5988

Order No : 2023-2024/HBC/2809

Dispatch Date: Dec 14 2023 1:06PM

Unit Id : 27890

Sources of Air Emissions	Pollution Control Measures	Prescribed	
		Parameter	Standard
Dg set(1010KVA)	ACOUSTIC ENCLOSURE , ADEQUATE AIR POLLUTION CONTROL MEASURES , ADEQUATE STACK HEIGHT , ADEQUATE STACK HEIGHT OF 30 MTR.	NOx (as NO2) (at 15% O2) day basis in ppmv	710 mg/Nm3
		NMHC (as C) (at 15% O2)	100 mg/Nm3
		PM (at 15% O2)	75 mg/Nm3
		CO (at 15% O2)	150 mg/Nm3

7 That the Domestic Sewage shall be treated before disposal so as to conform to the standards prescribed by the Board as notified under the Environment (Protection) Act-1986 for disposal **Into Inland Surface Water**. The main parameters for regular monitoring shall be as under:





Head Office HBC

Rajasthan State Pollution Control Board
4, Institutional Area, Jhalana Doongari, Jaipur-302 004

Phone: 0141-2716840

Registered

File No : F(HDF)/JAIPUR(Sanganer)/6935(1)/2023-2024/5986-5988

Order No : 2023-2024/HBC/2809

Dispatch Date: Dec 14 2023 1:06PM

Unit Id : 27890

Parameters	Standards
Oil and Grease	Not to exceed 10 mg/l
pH Value	Between 6.5 to 9.0
Biochemical Oxygen Demand (3 days at 27C)	Not to exceed 10 mg/l
Chemical Oxygen Demand	Not to exceed 50 mg/l
NH4 (N)	5 mg/l
N total	10 mg/l
Total Suspended Solids	Not to exceed 20 mg/l
Fecal Coliform (MPN per 100 ml)	Not to exceed 100

- 8 That the unit shall obtain all necessary permission from District Administration, Jaipur and Government of Rajasthan related to establishment of new academic block "Block-3" in "Manipal University", Khasra No 467, 469, 474, 458/1, 473, 475, 542, 544 Village Dehmi Kalan, Tehsil Sanganer, Ajmer Road, Tehsil: Sanganer District: JAIPUR, Rajasthan.
- 9 That this consent to establish is being issued for Academic Block-3 for Gross Built Up area: 21,525 Sq.m. For any change in area, the unit has to seek fresh consent to establish.
- 10 That if the project cost exceeds Rs. 104 Crore, the unit shall take/obtain modification in consent after paying fee as applicable.
- 11 That the unit shall provide adequate & safe infrastructure facility (step ladder) for monitoring at stack of D.G. set.
- 12 That the unit shall apply for CTO for Built up area @ 21,525 sq.m. within 15 days time period.
- 13 That the unit shall get amendment in all the previous CTOs for correct Built up area, where the same have been obtained for increased Built up area as compared to approved map.





Head Office HBC

Rajasthan State Pollution Control Board
4, Institutional Area, Jhalana Doongari, Jaipur-302 004

Phone: 0141-2716840

Registered

File No : F(HDF)/JAIPUR(Sanganer)/6935(1)/2023-2024/5986-5988

Order No : 2023-2024/HBC/2809

Dispatch Date: Dec 14 2023 1:06PM

Unit Id : 27890

- 14 That unit shall comply standards as specified in Environment (Protection) Act,1986, (Limiting concentration in mg/l, except for pH):
 - i. pH: 6.5-9.0
 - ii. BOD 3days, 27 degree Celsius: 10
 - iii. COD: 50
 - iv. Oil & Grease : 10
 - v. TSS: 20
 - vi. N-total : 10
 - vii. Fecal Coliform : 100 MPN/100 ml
 - viii. NH₄-N : 5
- 15 That the unit shall comply with the standards as prescribed vide MOEF notification no. GSR 826(E) dated 16th November, 2009 with respect to National Ambient Air Quality.
- 16 That the unit shall ensure compliance of ambient air quality standard in respect of noise as prescribed under Environment (Protection) Act & Rules made therein.
- 17 That unit shall provide adequate stack height along with acoustic enclosures on one D.G. set of 1010 KVA. Further unit shall not allow installing any air pollution source i.e. Boiler/Hot water generation etc. without prior consent to establish from the Board under the Air Act 1981.
- 18 That the total water consumption shall not exceed 30 KLD. The ground water shall not be abstracted without prior NOC from Central Ground Water Authority.
- 19 That the water flow meters shall be provided at all suitable points to measure quantity of daily water consumption, waste water generation, waste water treated and treated waste water recycled and utilized for plantation/gardening purposes. Daily record of the same shall be maintained and to be submitted to the Board.
- 20 That the unit shall ensure proper recycling and reuse of domestic waste water after adequate treatment.
- 21 That the entire domestic waste water generated in tune of 24 KLD shall be treated through existing sewage treatment plant having capacity of 500 KLD (150 KLD +350 KLD).
- 22 That the unit shall maintain condition of STP of capacity 500 KLD (150 KLD +350 KLD) to achieve the standards prescribed under EP Act 1986 and the unit shall dispose the sludge of STP in scientific manner.
- 23 That the unit shall provide disinfection system for STP treated water before its utilization in plantation/horticulture purpose.
- 24 That the unit shall dispose the sludge of STP in scientific manner.
- 25 That the unit shall not allow making any obstacles to any natural water flow i.e. natural nallah/stream carrying rain water to any water body.





Head Office HBC

Rajasthan State Pollution Control Board
4, Institutional Area, Jhalana Doongari, Jaipur-302 004

Phone: 0141-2716840

Registered

File No : F(HDF)/JAIPUR(Sanganer)/6935(1)/2023-2024/5986-5988

Order No: 2023-2024/HBC/2809

Dispatch Date: Dec 14 2023 1:06PM

Unit Id : 27890

- 26 That the unit shall install adequately designed rain water harvesting structure for prevention and recharge of ground water in and around the area.
- 27 That energy conservation measures like installation of CFLs/FLs for lighting the areas outside the building should be integral part of the project design and should be in place before project commissioning.
- 28 That used CFL/FLs/LEDs should be properly collected and disposed off/sent for re-cycling as per prevailing rules/guidelines issued by regulatory authority. Use of solar panels also be done to the extent possible.
- 29 That the solid waste generated should be properly collected & segregated. Wet garbage should be composted and dry/inert solid waste should be disposed off at approved sites for land filling after recovering recyclable materials.
- 30 That the unit shall comply with the provisions of Hazardous and Other Wastes(Management and Transboundary Movement) Rules, 2016; Solid Waste Management Rules, 2016; Plastic Waste Management Rules 2016; Construction And Demolition Waste Management Rules 2016; Bio-Medical Waste Management Rules, 2016 and E- Waste Management Rules, 2016.
- 31 That the unit shall ensure proper recycling and reuse of domestic waste water after adequate treatment.
- 32 That waste water shall always be conveyed/ carried through closed conduit pipe line and no other measure of carrying waste water such as tankers, flexible or temporary pipe line shall be used/practiced.
- 33 That water meters shall be installed at suitable locations at closed conduit pipe line to measure the quantity of effluent reaching to 500 KLD (150 KLD +350 KLD) STP for treatment.
- 34 That the surplus/excess/unutilized treated water shall be used for agriculture/plantation.
- 35 That unit shall utilize entire treated waste water for flushing/process/gardening/non-potable uses and other gainful purpose and zero discharge status shall be maintained outside the premises. No waste water shall be discharged on land/ into sewer line/into natural nala/water body/drain
- 36 That the unit shall not allow making any obstacles to any natural water flow i.e. natural nallah/stream carrying rain water to any water body.
- 37 That this consent is being issued on the basis of information /documents submitted by the industry. In case, it is found during post inspection that, the unit has flouted the conditions of consent or provided inadequate control measures & wrong information, the consent may be revoked and action may be initiated under the Provisions of Water Act & Air Act without any further notice.





Head Office HBC

Rajasthan State Pollution Control Board
4, Institutional Area, Jhalana Doongari, Jaipur-302 004

Phone: 0141-2716840

Registered

File No : F(HDF)/JAIPUR(Sanganer)/6935(1)/2023-2024/5986-5988

Order No : 2023-2024/HBC/2809

Dispatch Date: Dec 14 2023 1:06PM

Unit Id : 27890

- 38 That the industry shall comply provisions 9(4) & 13(2) of Plastic Waste Management (PWM) Rules -2016 and as amended & shall submit application for registration in form-I to State Board.
- 39 That no Single use Plastic (SUP) items, which are banned vide Ministry of Environment, Forest and Climate Change (MoEF& CC), Government of India notification dated 12/08/2021 shall be used in the unit premises.
- 40 That this consent to establish shall be subject to compliance of any direction or order passed by Court of Law/NGT/CAQM in the matter.
- 41 That the unit shall obtain necessary permission from National Board for Wildlife Clearance (NBWL), if the project falls in ESZ of Notified protected Area and the activity is not covered under permitted activity. The consent is granted under the provisions of Water Act, 1974 and Air Act, 1981 and any other permission/consent w.r.t. Environment Protection Act, 1986 and Forest Conservation Act, 1980, if required, shall have to be obtained before implementation of the project.
- 42 That all the green building concepts/ norms shall be adopted in all possible ways which includes Green walls, solar energy etc., and compliance of this condition shall be submitted along with photograph during the time of CTO application.
- 43 That proper C&D mechanism shall be adopted, and compliance of this condition shall be submitted along with photograph during the time of CTO application.
- 44 That proper wash disposal system shall be developed, and compliance of this condition shall be submitted along with photograph during the time of CTO application.
- 45 That water harvesting system shall be developed for maximum storage and moisture improvement, and compliance of this condition shall be submitted along with photograph during the time of CTO application.
- 46 That proper ventilation measures for energy saving, less toxic materials for reducing indoor pollution and usage of certified wood shall be considered, and compliance of this condition shall be submitted along with photograph during the time of CTO application.
- 47 That proper waste segregation system to be developed.
- 48 That the unit shall take steps to enhance landscaping and green cover in all possible spaces and develop green belt in at least 33% of the total project area.
- 49 That, notwithstanding anything provided hereinabove, the State Board shall have the power and reserves its right, as contained under Section 27(2) of the Water Act and under Section 21(6) of the Air Act to review anyone or all of the conditions imposed here in above and to make such variation as it deems fit for the purpose of compliance of the Water Act and Air Act.





Head Office HBC
Rajasthan State Pollution Control Board
4, Institutional Area, Jhalana Doongari, Jaipur-302 004

Phone: 0141-2716840

Registered

File No : F(HDF)/JAIPUR(Sanganer)/6935(1)/2023-2024/5986-5988

Order No : 2023-2024/HBC/2809

Dispatch Date: Dec 14 2023 1:06PM

Unit Id : 27890

50 That the grant of this **Consent to Establish** is issued from the environmental angle only, and does not absolve the project proponent from the other statutory obligations prescribed under any other law or any other instrument in force. The sole and complete responsibility, to comply with the conditions laid down in all other laws for the time-being in force, rests with the industry/ unit/ project proponent.

51 That the grant of this **Consent to Establish** shall not, in any way, adversely affect or jeopardize the legal proceedings, if any, instituted in the past or that could be instituted against you by the State Board for violation of the provisions of the Act or the Rules made thereunder.

This **Consent to Establish** shall also be subject, besides the aforesaid specific conditions, to the general conditions given in the enclosed Annexure. The project proponent will comply with the provisions of the **Water Act and Air Act** and to such other conditions as may, from time to time, be specified by the State Board under the provisions of the aforesaid Act(s). Please note that, non compliance of any of the above stated conditions would tantamount to revocation of **Consent to Establish** and project proponent / occupier shall be liable for legal action under the relevant provisions of the said Act(s).

This bears approval of the competent authority.

Yours sincerely,

Group Incharge[HBC]

(A): **Copy to:-**

- 1 Regional Officer, Regional Office, Rajasthan State Pollution Control Board, Jaipur (south) with request to ensure compliance of consent conditions.
- 2 Master File.

Group Incharge[HBC]



नगर निगम, जयपुर ग्रेटर

(राजस्थान नगरपालिका अधिनियम 2009 की धारा के अन्तर्गत)

अनापत्ति प्रमाण पत्र

आवेदन नं.: LSG/JAIPUR GREATER/FIRENOC/2023-24/24339

जारी दिनांक: 01-DEC-2023

प्रेषित-

आवेदक का नाम श्री/श्रीमती: NITU BHATNAGAR

आवेदक का पता: DEHMI KALAN, AJMER JAIPUR EXPRESSWAY, JAIPUR

विषय:- अग्निशमन अनापत्ति प्रमाण पत्र जारी करने बाबत

आपके भवन MANIPAL UNIVERSITY JAIPUR, NEW ACADEMIC BLOCK 3, DEHMI KALAN, DEHMI KALAN, JAIPUR, RAJASTHAN का निरीक्षण किया गया निरीक्षण के दौरान अग्नि सुरक्षा उपकरण सही पाए गए अतः उपरोक्त सुरक्षा व्यवस्था के अनुसार निम्न शर्तों पर पाबंद करते हुए यह स्थाई (Permanent) अनापत्ति प्रमाण पत्र जारी किया जाता है।

शर्तें:-

- अनापत्ति प्रमाण पत्र जारी करने कि तिथि से एक वर्ष कि अवधि हेतु ही मान्य होगा। एक वर्ष बाद अनापत्ति प्रमाण पत्र का नवीनीकरण किया जाना आवश्यक होगा, अन्यथा अनापत्ति स्वतः निरस्त मानी जावेगी।
- भवन के समस्त स्टाफ व सिविलोरेटी गार्डस को वर्ष में कम से कम दो बार अग्निशमन विभाग द्वारा प्रशिक्षण दिलाना आवश्यक होगा।
- अग्निशमन उपकरण समयावधि में रीफिल कराना होगा।
- निरीक्षण के दौरान आवश्यक दिशा निर्देशों का पालन करना आवश्यक होगा।
- यदि राज्य सरकार या निगम द्वारा भविष्य में कोई नियम/उपनियम जारी किया जाता है तो प्रबंधक को मान्य होगा।
- भवन का मुख्य अग्निशमन अधिकारी द्वारा कभी भी निरीक्षण किया जा सकेगा व फायर सिस्टम कार्यरत नही पाए जाने कि स्थिति में यह अभिशंषा पत्र निरस्त माना जाएगा।
- पानी के टैंक हर समय भरे रखने होंगे व पम्प व पूरा फायर सिस्टम 24 घण्टे कार्यशील स्थिति में रखने को बाध्य होंगे।
- फायर सिस्टम को चलाने हेतु 24 घंटे फायर प्रशिक्षित कर्मचारी रखने होंगे तथा ए एम सी करवायी जाकर सिस्टम का रख रखाव व संचालन करना अनिवार्य होगा।
- फायर वाहन आसानी से आ जा सके इसके लिए पर्याप्त खुला स्थान अवरोध रहित रखना होगा।
- भवन के अंदर किसी भी प्रकार का विस्फोटक पदार्थ व अति ज्वलनशील पदार्थ नही रखा जावे।
- रोप लेडर व दो रस्सा भवन के सभी टावर में टावर कि उंचाई जितना हर समय भवन में रखना होगा।
- यह अग्नि सुरक्षा प्रमाणपत्र अग्नि सुरक्षा की दृष्टि से ही मान्य होगा।
- भूमि व भवन संबंधित किसी भी प्रकार के विवाद हेतू यह पत्र बतौर साक्ष्य मान्य नही होगा एवं इस बाबत आवेदक स्वयं उत्तरदायी होगा।
- यह अनापत्ति प्रमाण पत्र रूफटोप रेस्टोरेट के लिए मान्य नहीं हैं। जिस भाग के लिए अनापत्ति प्रमाण पत्र जारी किया जा रहा है वहा पर रूफटोप रेस्टोरेट का संचालन पूर्णतया प्रतिबंधित रहेगा।

अग्निशमन अधिकारी
नगर निगम, जयपुर ग्रेटर

State Level Environment Impact Assessment Authority, Rajasthan
4, Institutional Area, Jhalana Doongri, Jaipur-302004
Phone: 0141-2705633, 2711329 Ext. 361

No. F1 (4)/SEIAA/SEAC-Raj/Sectt/Project/Cat. 8(a)B1/(194)/08-09

Jaipur, Dated: 27.11.2012

M/s Manipal Universal Learning P. Ltd.

Manipal Towers,
14-HAL Airport Road,
Bangalore

Sub:- Regarding change of name in Environmental Clearance dt. 29.12.2009 from "Manipal Education Project" to "Manipal University, Jaipur".

Ref:- Your request letter no. nil dated 6.11.12 and letter no. MUJ /REGI/Govt./2012/ Spl-1 dt. 16.11.12

Sir,

With reference to the above subject & your request letters cited above, the matter was discussed in the 42nd meeting of SEIAA, and following amendments is made in the subject of environmental clearance issued vide this Authority's letter of even number dated 29.12.09:-

1. In the subject of the letter, the words "Manipal Education Project" shall be replaced by "Manipal University Jaipur".

Yours faithfully

Sd.
(Sankatha Prasad)
Member Secretary
SEIAA Rajasthan

Copy to following for information and necessary action:

1. Secretary, Ministry of Environment and Forest, Govt, of India, Paryavaran Bhavan, CGO Complex, Lodhi Road, New Delhi.
2. Addl. Chief Secretary, Environment Department, Rajasthan, Jaipur.
3. Smt. Alka Kala, Chairman, SEIAA, Rajasthan, 69-A Bajaj Nagar Enclave, Jaipur
4. Shri Moti Lal Daima, Member, SEIAA, Rajasthan, 48/9, Moti Path, Mansarovar, Jaipur.
5. Member Secretary, Rajasthan State Pollution Control Board, Jaipur for information & necessary action and to display this sanction on the website of the Rajasthan State Pollution Control Board, Jaipur.
6. Secretary, SEAC Rajasthan.
7. The CCF, Regional Officer, Ministry of Environment & Forests, RO (CZ), Kendriya Bhawan, 5th Floor, Sector "H", Aliganj, Lucknow- 226020.
8. IA- Division, Monitoring Cell, MoEF, Paryavaran Bhavan, CGO Complex, Lodhi Road, New Delhi - 110003
- ✓ 9. Nodal Officer (Department Website), Department of Environment, Government of Rajasthan Jaipur with the request to upload the copy of this environmental clearance on the website.

M.S.
M.S. SEIAA (Rajasthan)

State Level Environment Impact Assessment Authority, Rajasthan

4, Institutional Area, Jhalana Doongri, Jaipur-302004
Phone: 0141-2705633, 2711329 Ext. 361

No: FI/4/SEIAA/SEAC-Raj/Sectt/Project/Cat 8(a)B1 (194)/08-09

Jaipur, Dated: 27-12-09

To,
M/s Manipal Universal Learning P. Ltd.,
Manipal Towers,
14-HAL Airport Road,
Bangalore

Sub: EC for proposed Manipal Education Project village Dehmi Kalan, Teh. Sanganer, Jaipur by Mr. R.Shankar, V.P. (Project), Manipal Universal Learning P. Ltd., Manipal Towers, 14-HAL Airport Road, Bangalore.

Sir,
This has reference to your application No Nil dated 12-06-09 seeking environmental clearances for the above project under EIA Notification 2006. The proposal has been appraised as per prescribed procedure in the light of provisions under the EIA Notification 2006 on the basis of the mandatory documents enclosed with the application viz. the questionnaire, EIA EMP and additional clarifications furnished in response to the observation of the State Level Expert Committee Rajasthan, in its meetings held on 18/19.11.09.

2. Brief details of the Project:

- | | | |
|-----|-------------------------------|--|
| 1. | Category: | "B" |
| 2. | Item No (in the Schedule): | 8(a) |
| 3. | Purpose | Educational Project |
| 4. | Location | Village-Dehmi Kalan, Tehsil-Sanganer, Distt.-Jaipur. |
| 5. | Total Plot area | 2,69,801.80 M ² . (66.67 Acres / 26.98Ha) |
| 6. | Built Up Area | 2,31,242.75 M ² . |
| 7. | Utilized ground coverage: | 14.48 %. |
| 8. | FAR | Achieved FAR 68% |
| 9. | Maximum Building Height | Not Provided. |
| 10. | No. of Floors | Not Provided. |
| 11. | Total Parking Area | 40,000 M ² under surface parking. Parking provided for 670 Cars, 536 Two Wheelers, 135 Cycles. |
| 12. | Expected Cost: - | Rs. 583 Crores - Development Cost; Rs. 30,194 Crores - Land Cost |
| 13. | Power Requirement | 8 MVA during I-Phase through RSEB Installation of 4 DG Sets proposed (2x2000 KVA, 2x1000 KVA; Diesel consumption @ 5.4 ltr/hour). |
| 14. | Water Requirement & Source | -928 KLD. Source: Tube Wells.
A letter dt. 03.10.2009 has been sent by the P.P. to the Central Ground Water Authority for permission to install the required 6 nos. of tube wells. |
| 15. | Environmental Management Plan | 1) 52018.50 M ² (approx. 23 %) is available under parks and green belt.
2) 40,000 Sq. M. is available for surface parking.
3) Rain Water Harvesting
4) A STP of 1075 KLD capacity. |

TSA
27/12/09
04/01/10

27/12/09
04/01/10

3. The SEAC Rajasthan after due considerations of the relevant documents submitted by the project proponent and additional clarifications/documents furnished to it have recommended for Environmental Clearance with certain stipulations. The SEIAA Rajasthan after considering the proposal and recommendations of the SEAC Rajasthan hereby accord Environmental Clearance to the project as per the provisions of Environmental Impact Assessment Notification 2006 and its subsequent amendments, subject to strict compliance of the terms and conditions as follows:

A

PART A: SPECIFIC CONDITIONS

I. CONSTRUCTION PHASE

- i. "Consent to Establish" shall be obtained from Rajasthan State Pollution Control Board and a copy shall be submitted to the SEIAA, Rajasthan before start of any construction work at the site and submit the following documents to RPCB at the time of applying for CTE:
 - ✓ Identification of re-cycling plant with its process.
- ii. For conservation of electricity and to reduce energy losses the management should ensure that the electrical voltage is stepped down from 33 KV to 11 KV and distributed at this level and finally brought to 440 volts.
- iii. Provision shall be made for the housing of construction labor within the site with all necessary infrastructure and facilities such as fuel for cooking, mobile toilets, mobile ST safe drinking water, medical health care, crèche etc. The housing may be in the form of temporary structures to be removed after the completion of the project.
- iv. All required sanitary and hygienic measures shall be in place before starting construction activities. The safe disposal of waste water and solid waste generated during the construction phase should be ensured.
- v. Adequate drinking water facilities shall be provided for construction workers at the site.
- vi. Provisions should be made for the supply of fuel (kerosene or cooking gas); utensils such as pressure cookers etc. to the labourers.
- vii. All the labourers engaged for construction should be screened for health and adequately treated before engaging them to work at the site.
- viii. For disinfection of waste water, appropriate tertiary treatment may be given.
- ix. All the topsoil excavated during the construction should be stored for use in horticulture/landscape development within the project site.
- x. Disposal of muck during construction phase should not create any adverse effect on the neighboring communities and be disposed taking the necessary precautions for general safety and health aspects of the people, only in approved sites with the approval of competent authority.
- xi. Soil and ground water samples will be tested to ascertain that there is no threat to the ground water quality by leaching of heavy metals and other toxic contaminants.
- xii. Construction spoils, including bituminous material and other hazardous materials must not be allowed to contaminate water courses and the dump sites for such material must be secured so that they do not leach into the ground water.
- xiii. The diesel generator sets to be used during the construction phase should be low-sulphur-diesel type and should conform to Environment (Protection) Rules for air and noise emission standards.
- xiv. Vehicles hired for bringing construction material and labourers to the site should be in good conditions and should conform to applicable air and noise emission standards and should be operated during non-peak/approved hours.
- xv. Ambient noise levels should conform to residential standards both during day and night. Incremental pollution loads on the ambient air and noise quality should be closely monitored during construction phase.
- xvi. Fly ash should be used as building material in the construction as per the provisions of Fly Ash notification of September, 1999 and amended as on August, 2003 (The above condition is applicable only if the project is within 100 km of Thermal Power Station).
- xvii. Ready mixed concrete must be used in building construction.
- xviii. Storm water control and its re-use as per CGWA and BIS standards for various applications.
- xix. Water demand during construction should be reduced by the use of pre-mixed concrete, curing agents and other best practices.
- xx. Permission to draw ground water shall be obtained from the CGWA/CGWB prior to construction/operation of the project.
- xxi. Separation of grey and black water should be done by the use of dual plumbing line for separation of grey and black water.
- xxii. Treatment of 100% grey water by decentralized treatment should be done.
- xxiii. Fixtures for showers, toilet flushing and drinking should be of low flow either by use of aerators or pressure reducing devices or sensor based control.
- xxiv. Use of glass may be reduced by up to 40% to reduce the electricity consumption and load in air-conditioning. If necessary, use high quality double glass with special reflective coating windows.
- xxv. Roof should meet prescriptive requirement as per Energy Conservation Building Code by using appropriate thermal insulation material to fulfill requirement.

- 13
- 28
- xxv. Adequate measures shall be taken to reduce air and noise pollution during construction keeping in mind CPCB norms on noise limits.
 - xxvi. Opaque walls should meet prescriptive requirement as per Energy Conservation Building Code for all air-conditioned spaces, whereas, for non-air-conditioned spaces, by use of appropriate thermal insulation material to fulfill the requirement.
 - xxvii. A First Aid Room will be provided in the project both during construction and operation of the project.
 - xxix. Any hazardous waste generated during construction phase should be disposed off as per applicable rules and norms with necessary authorization of the Rajasthan Pollution Control Board.
 - xxx. The approval of the competent authority shall be obtained for structural safety of the building due to earthquake, adequacy of fire fighting equipments, etc as per National Building Code 2005 including protection measures from lightening etc.
 - xxx. Regular supervision of the above and other measures for monitoring should be in place through out the construction phase, so as to avoid nuisance to the surroundings.
 - xxxii. Approved plan from competent Authority and position with reference to Master Plan.
 - xxxiii. Copy of guidelines issued by concerned ministry for water scarce area is provided.
 - xxxiv. Ground water table to be shown along with source. Besides, permission of competent authority is obtained for withdrawal of ground water.
 - xxxv. Recalculate MSW quantity and revise disposal proposal.
 - xxxvi. Composting of biodegradable waste shall be carried out within the campus.
 - xxxvii. Provision of solar water heating /chilling etc shall be explored.
 - xxxviii. Review and revise the requirement of DG set capacities for 100% power back up through to optimization of power back up in case of power failure and emergency.

II OPERATION PHASE

- i. An independent expert shall certify the installation of the Sewage Treatment Plant (STP) and a report in this regard shall be submitted to the RPCB, before the project is commissioned for operation. Discharge of treated sewage shall conform to the norms & standards of the Rajasthan State Pollution Control Board.
- ii. For conservation of electricity and to reduce energy losses the management should ensure that the electrical voltage is stepped down from 33 KV to 11 KV and distributed at this level and finally brought to 440 volts.
- iii. Rain Water harvesting (RWH) for roof run-off and surface run-off, as plan submitted shall be implemented. Before recharging the surface run off, pre-treatment must be done to remove suspended matter, oil and grease. The RWH plan should as per GOI manual.
- iv. The solid waste generated should be properly collected & segregated before disposal to the City Municipal Facility. The in-vessel bio-conversion technique may be used for composting the organic waste.
- v. Any hazardous waste including biomedical waste should be disposed of as per applicable Rules & norms with necessary approvals of the Rajasthan State Pollution Control Board.
- vi. The green belt design along the periphery of the plot shall achieve attenuation factor conforming to the day and night noise standards prescribed for residential land use. The open space inside the plot should be suitably landscaped and covered with vegetation of indigenous variety.
- vii. The D. G. sets to be operated with stack height as per RPCB norms.
- viii. Incremental pollution loads on the ambient air quality noise and water quality shall be periodically monitored after commissioning of the project.
- ix. Application of solar energy should be incorporated to illumination of common areas, lighting for gardens and street lighting in addition to provision for solar water heating. A hybrid system or fully solar system for a portion of the apartments should be provided.
- x. Traffic congestion near the entry and exit points from the roads adjoining the proposed project site must be avoided. Parking should be fully internalized and no public space should be utilized.
- xi. A Report on the energy conservation measures conforming to energy conservation norms finalized by Bureau of Energy Efficiency should be prepared incorporating details about building materials & technology, R & U Factors etc. Quantify energy saving measures.
- xii. Proper system of channelizing excess storm water shall be provided.
- xiii. The power factor should be maintained near unity.
- xiv. Trees and shrubs of local species should be planted to allow habitat for birds with appropriate distance from the boundary.
- xv. No puzzle parking shall be allowed.
- xvi. Re-cycled water to match standards for cooling water system.
- xvii. Adequate measures should be taken to prevent odor from solid waste processing and STP.

PART - B. GENERAL CONDITIONS:

1. The environmental safeguards contained in Form I-A should be implemented in letter and spirit.
2. Six monthly monitoring reports should be submitted to Rajasthan and Rajasthan State Pollution Control Board.
3. Officials of the RPCB, who would be monitoring the implementation of environmental safeguards, should be given full cooperation facilities and documents/data by the PP during their inspection. A complete set of all the documents submitted to SEIAA, Rajasthan should be forwarded to the DCE, Rajasthan and Rajasthan State Pollution Control Board.
4. In case of any change(s) in the scope of the project, the PP requires a fresh appraisal by SEIAA/SEAC, Rajasthan.
5. The SEIAA/SEAC, Rajasthan reserves the right to add additional safeguard measures subsequently, if found necessary, and to take action including revoking of the environmental clearance under the provisions of the Environment (Protection) Act-1986, to ensure effective implementation of the suggested safeguard measures in a time bound and satisfactory manner.
6. All the other statutory clearances such as the approvals for storage of diesel from the Chief Controller of Explosives, Fire department, Civil Aviation Department, Forest Conservation Act, 1980 and Wildlife (protection) Act, 1972 etc. shall be obtained, as may be applicable, by PP from the competent authority.
7. The PP should ensure advertising in at least two local news papers widely circulated in the region, one of which shall be in vernacular language that, the project has been accorded environmental clearance and copies of the clearance letters are available with SEIAA, Rajasthan and the Rajasthan State Pollution Control Board and may also be seen on the website of the Board at www.rpcb.nic.in. The advertisement should be made within 7(seven) days from the date of issue of the environmental clearance and a copy should also be forwarded to the SEIAA, Rajasthan and Regional Office, Jaipur(S) of the Board.
8. These stipulations would also be enforced amongst the others under the provisions of Water (Prevention and Control of Pollution) Act, 1974, the Air (Prevention and Control of Pollution) Act, 1981, the Environment (Protection) Act, 1986, the Public Liability (Insurance) Act, 1991 and EIA Notification, 2006.
9. Environment clearance is subject to final order of the Hon'ble Supreme Court of India in the matter of Goa Foundation Vs. Union of India in Writ Petition(Civil) No. 460 of the year 2004 as may be applicable to this project.

Yours faithfully,

Sd/-
(Sankatha Prasad)
Member Secretary
SEIAA Rajasthan

Copy to following for information and necessary action:

1. Secretary, Ministry of Environment and Forest, Govt. of India, Paryavaran Bhavan, CGO Complex, Lodhi Road, New Delhi.
2. Principal Secretary, Environment Department, Rajasthan, Jaipur.
3. Shri S.C. Derashri, Chairman, SEIAA Rajasthan, 90, Geejgarh Vihar, Hawa Sarak, Jaipur.
4. Shri R.S. Bhandari, Member, SEIAA Rajasthan, 2- Museum Road, Ram Niwas Bagh, Jaipur.
5. Member Secretary, Rajasthan State Pollution Control Board, Jaipur.
6. Member Secretary, SEAC Rajasthan.
7. The CCF, Regional Office, Ministry of Environment & Forests, RO(CZ), Kendriya Bhawan, 5th Floor, Sector 'H', Aliganj, Lucknow-226 020.
8. IA- Division, Monitoring Cell, MoEF, Paryavaran Bhavan, CGO Complex, Lodhi Road, New Delhi-110003.

M.S. SEIAA (Rajasthan)

nexture
ointwise
pliance report of the EC

(88) Red Category

C:\Documents and Settings\Administrator\Desktop\Prasad\SEIAA\SEAC\EC Files\SEIAA\SEIAA EC from Sept 09.doc

RPCB-NIC in

4 consent to Establish - Water - Air -

A.A

operate -

DRG NO.
NAB-3-(01 & 02)

NOTES

THIS DEVELOPMENT HAVE BEEN CONCEIVED,DESIGNED AND DRAFTED ON THE BASIS OF THE FOLLOWING PARAMETERS:
1. ANY DISCREPANCY IN THE DRAWING IS TO BE BROUGHT TO THE NOTICE OF THE ARCHITECT IMMEDIATELY.
2. ALL DIMENSIONS ARE IN MILLIMETERS UNLESS OTHERWISE SPECIFIED.
3. ALL DIMENSIONS ARE FROM UNFINISHED TO UNFINISHED SURFACES UNLESS OTHERWISE SPECIFIED.
4. DRAWING NOT TO BE SCALED. ONLY WRITTEN DIMENSIONS ARE TO BE FOLLOWED.
5. DRAWING MUST BE READ IN CONJUNCTION WITH STRUCTURAL DRAWINGS.
6. THE SIZES OF ALL THE STRUCTURAL MEMBERS TO BE REFERRED FROM DRAWINGS OF STRUCTURAL CONSULTANT.
7. ALL CENTER LINE DIMENSIONS ARE WITH REFERENCE TO (0,0).

REVISIONS	DATE	DESCRIPTION	BY
0			
1	01-05-2013	ADDITION OF LIFT LOBBY AND STAIRCASE PRESSURIZATION SHAFT	DUO TO C.F.O. N.O.C.
2			
3			
4			
5			
6			
7			
8			
9			
10			

PROJECT MANAGEMENT CONSULTANT
DILLIGENT PMC
STRUCTURAL CONSULTANT
TRC
TRC Engineering (I) Pvt. Ltd.,
SERVICES CONSULTANT
MEP CONSULTING ENGINEERS

PROJECT:
PROPOSED ACADEMIC BLOCK,
MANIPAL UNIVERSITY JAIPUR
KHASRA. 467,469,474,468/1,473,475,542,544
GRAM: DEHMI KALAN
TEHSIL: SANGANEER
JAIPUR, RAJASTHAN

DRG.TITLE:
MASTER PLAN

REVISION	JOB NO.:	DRG NO.:	NORTH:
	4401		
	SCALE:	DATE:	
	A1: 1:100		
FILE:	DEALT BY:	CHECKED BY:	APPROVED BY:

SIGNATURE & SEAL OF ARCHITECT
Sulha
SIGNATURE & SEAL OF OWNER
Abh

Architect Hafeez Contractor
29 Bank Street, Bombay 400 023. Tel:2661920

ALREADY SANCTIONED BUILDINGS (AREA STATEMENT)

SL NO	PARTICULARS	GROSS BUILT UP AREA (SQ.MT.)	F.A.R. AREA (SQ.MT.)
1	UNIVERSITY ADMIN & LIBRARY BUILDING	23463	23076
2	ACADEMIC BLOCK-A	30628	30097
3	FOOD COURT	7954	7905
4	SECURITY	230	230
5	WORKSHOP (GROUND FLOOR)	1388	1388
6	SUBSTATION	120	120
7	D.G.BLOCK	307	307
8	DISPENSARY	228	228
9	VIP SECURITY BLOCK	62	62
10	TOTAL	64380	63413
11	NEW ACADEMIC BLOCK	31952	22865
12	AUTOMOBILE SHED	1050	830
13	FIRST FLOOR WORK SHOP BUILDING.	1542	1225
14	CHEMICAL ENGINEERING LAB - 3	369	291
15	CHEMICAL ENGINEERING RESEARCH LAB.	100	100
	TOTAL	99,393	88,724
	FURNITURE YARD	1050	830
	ALREADY APPROVED AREA (TOTAL)	1,00,443	89,554

EXTENSION (NEW SUBMISSIONS)		
PARTICULARS	GROSS BUILT UP AREA (SQ.MT.)	B.A.R. AREA (SQ.MT.)
1 NEW ACADEMIC BLOCK - 3	21,525.00	21,525.00

B.A.R. IN TOTALITY
ALREADY APPROVED (ACHIEVED) FAR = 0.331
CONVERTED INTO B.A.R. (BUILT AREA RATIO)
= FAR X 1.5 = 0.331 X 1.5 = 0.4965
PERMISSIBLE B A R (AS PER 2020 BUILDING BYLAWS)= 2.00
B A R OF THE PROPOSED NEW ACADEMIC BLOCK - 3 (NAB-3)
= B.A.R. AREA / SITE AREA
= 21,525.00 / 269804.00
= 0.079
TOTAL BAR OF THE PLOT
= 0.4965 + 0.079 = 0.5755 < 2

COMPREHENSIVE TABLE			
	ALREADY SANCTIONED	NEW PROPOSAL	TOTAL
GROSS BUA	1,00,443 Sq.mt.	21,525.00 sq.mt.	1,21,968 Sq.mt.
B.A.R. & AREA	F.A.R. ACHIEVED = 0.331<1 (Area=89,554 Sq.mt.)	(CONVERTED BAR) +(NAB-3) 0.4965 + 0.079 (21,525 sq.mt.)	= 0.5755 < 2 (1,11,079 sq.mt.)
GROUND COVERAGE	12.01 %	1.91 %	13.92 %
PARKING (ECU CAL.)	1494 (CAR -1121 & SCOOTER-1122)	206 (BUSES - 13, CAR -116 & SCOOTER-153)	1700 (BUSES - 13, CAR -1237 & SCOOTER-1275)
HEIGHT	15 M	15 M	

PROPOSED NEW ACADEMIC BLOCK - 3		
FLOOR	GROSS B U AREA	B. A. R.
GROUND	5678.00 sq.mt.	5678.00 sq.mt.
FIRST	5678.00 sq.mt.	5678.00 sq.mt.
SECOND	4961.00 sq.mt.	4961.00 sq.mt.
THIRD	4961.00 sq.mt.	4961.00 sq.mt.
TERRACE	247.00 sq.mt.	247.00 sq.mt.
TOTAL	21,525.00 sq.mt.	21,525.00 sq.mt.

REQUIRED E.C.U. CALCULATIONS
= B.A.R. / 115
= 21525.00 / 115
= 187.17
TOTAL E.C.U. = REQUIRED NO. + 10% VISITOR PARKING
= 187.17 + 18.70 = 205.87 = 206 E.C.U.
IN THIS 75 % BUSES & CARS, 25% SCOOTER PARKING.
TOTAL BUSES = (39 E.C.U. / 3) = NO. 13
TOTAL CARS = NO. 116
TOTAL SCOOTERS = (51 E.C.U. X 3) = NO. 153
OVERALL TOTAL BUSES = 13
OVERALL TOTAL CARS = 1121 + 116 = 1237
OVERALL TOTAL SCOOTERS = 1122 + 153 = 1275

PERMISSIBLE GROUND COVERAGE = 40%
ACHIEVED GROUND COVERAGE
= PLINTH AREA X 100 / SITE AREA
= 37569 X 100 / 2,69,804.00
= 13.92 %

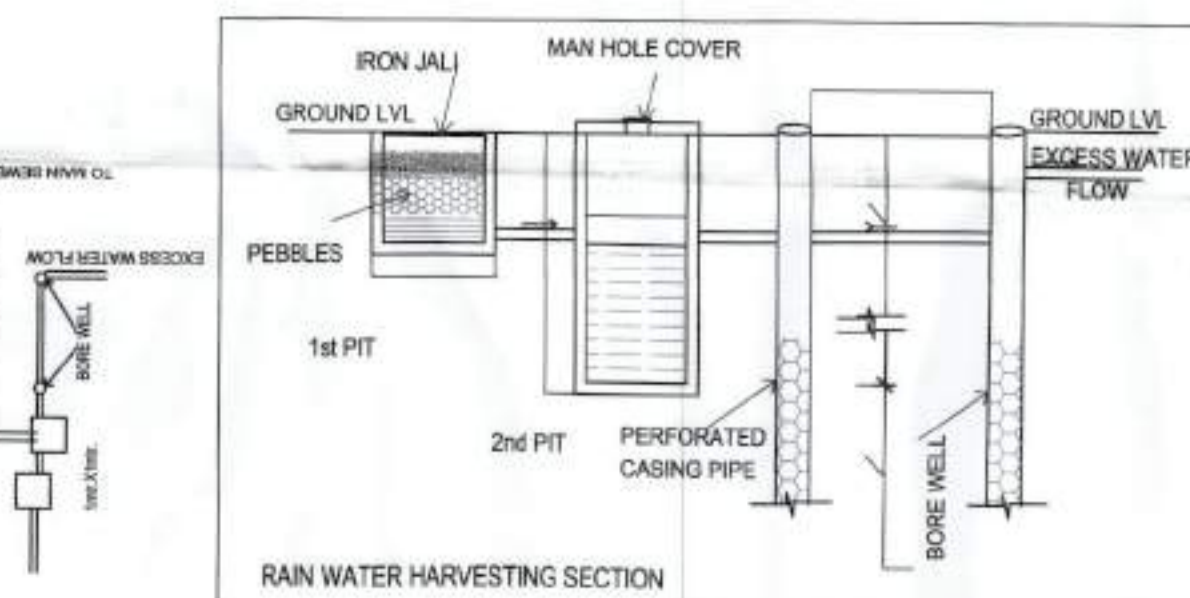

ALREADY SANCTIONED BUILDINGS.
PROPOSED BUILDINGS

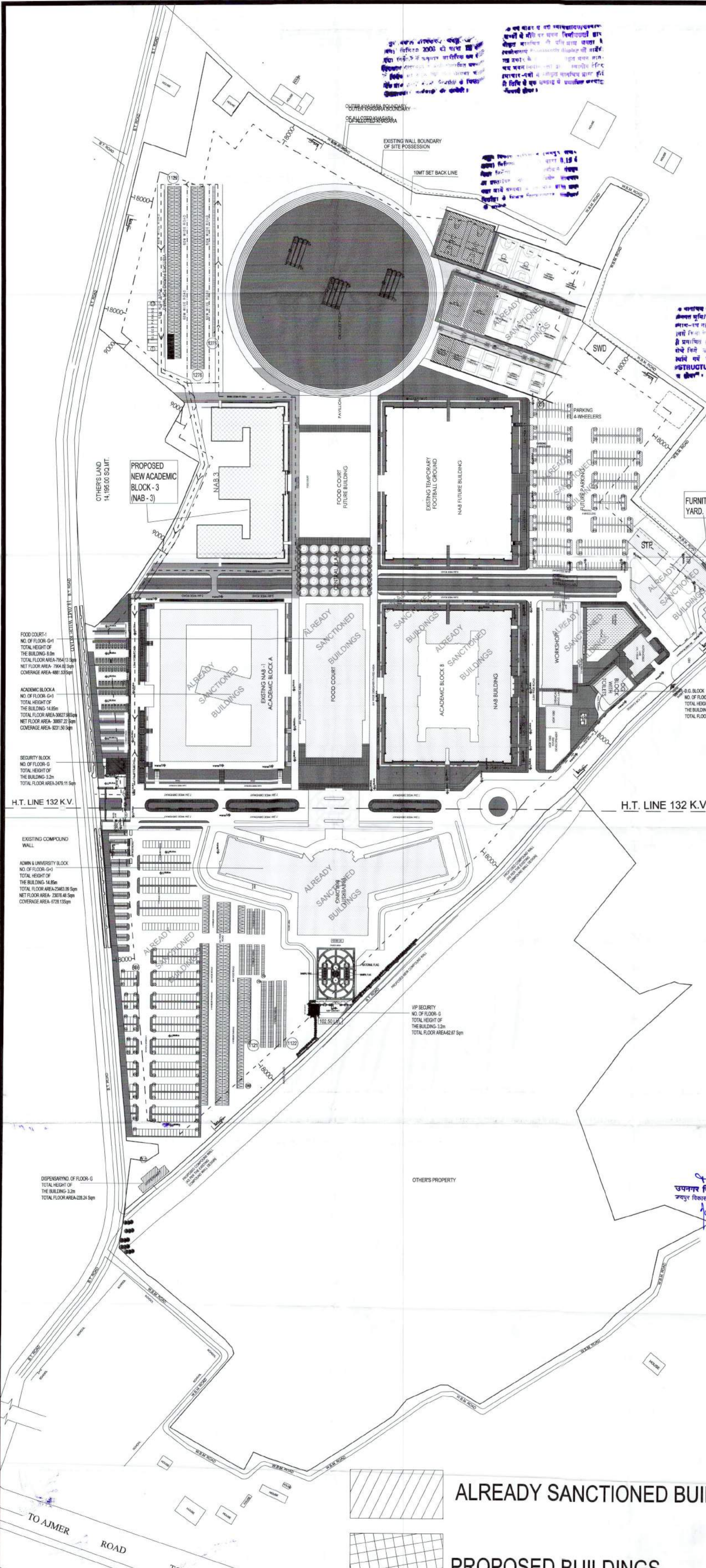

अनुमति प्राप्त है कि यह परियोजना/कार्यक्रम
अनुमति के बिना नहीं चलाया जायेगा।
अनुमति प्राप्त है कि यह परियोजना/कार्यक्रम
अनुमति के बिना नहीं चलाया जायेगा।
अनुमति प्राप्त है कि यह परियोजना/कार्यक्रम
अनुमति के बिना नहीं चलाया जायेगा।

अनुमति प्राप्त है कि यह परियोजना/कार्यक्रम
अनुमति के बिना नहीं चलाया जायेगा।
अनुमति प्राप्त है कि यह परियोजना/कार्यक्रम
अनुमति के बिना नहीं चलाया जायेगा।

अनुमति प्राप्त है कि यह परियोजना/कार्यक्रम
अनुमति के बिना नहीं चलाया जायेगा।
अनुमति प्राप्त है कि यह परियोजना/कार्यक्रम
अनुमति के बिना नहीं चलाया जायेगा।

अनुमति प्राप्त है कि यह परियोजना/कार्यक्रम
अनुमति के बिना नहीं चलाया जायेगा।
अनुमति प्राप्त है कि यह परियोजना/कार्यक्रम
अनुमति के बिना नहीं चलाया जायेगा।

अनुमति प्राप्त है कि यह परियोजना/कार्यक्रम
अनुमति के बिना नहीं चलाया जायेगा।
अनुमति प्राप्त है कि यह परियोजना/कार्यक्रम
अनुमति के बिना नहीं चलाया जायेगा।

अनुमति प्राप्त है कि यह परियोजना/कार्यक्रम
अनुमति के बिना नहीं चलाया जायेगा।
अनुमति प्राप्त है कि यह परियोजना/कार्यक्रम
अनुमति के बिना नहीं चलाया जायेगा।

DRG NO. NAB -3 - (03)

NOTES

THIS DEVELOPMENT HAS BEEN CONCEPT DESIGNED AND DRAFTED ON THE BASIS OF THE FOLLOWING PARAMETERS:
1. ANY DISCREPANCY IN THE DRAWING IS TO BE BROUGHT TO THE NOTICE OF THE ARCHITECT IMMEDIATELY.
2. ALL DIMENSIONS ARE IN METERS UNLESS OTHERWISE SPECIFIED.
3. ALL DIMENSIONS ARE FROM UNFINISHED TO UNFINISHED SURFACES UNLESS OTHERWISE SPECIFIED.
4. DRAWINGS NOT TO BE SCALED. ONLY WRITTEN DIMENSIONS ARE TO BE FOLLOWED.
5. DRAWINGS ARE TO BE READ IN CONJUNCTION WITH STRUCTURAL DRAWINGS.
6. THE SIZES OF ALL THE STRUCTURAL MEMBERS TO BE REFERRED FROM DRAWINGS OF STRUCTURAL CONSULTANT.
7. ALL CENTER LINE DIMENSIONS ARE WITH REFERENCE TO 500L.

Table with 4 columns: REVISION, DATE, DESCRIPTION, BY. Contains one revision entry dated 01-05-2018.

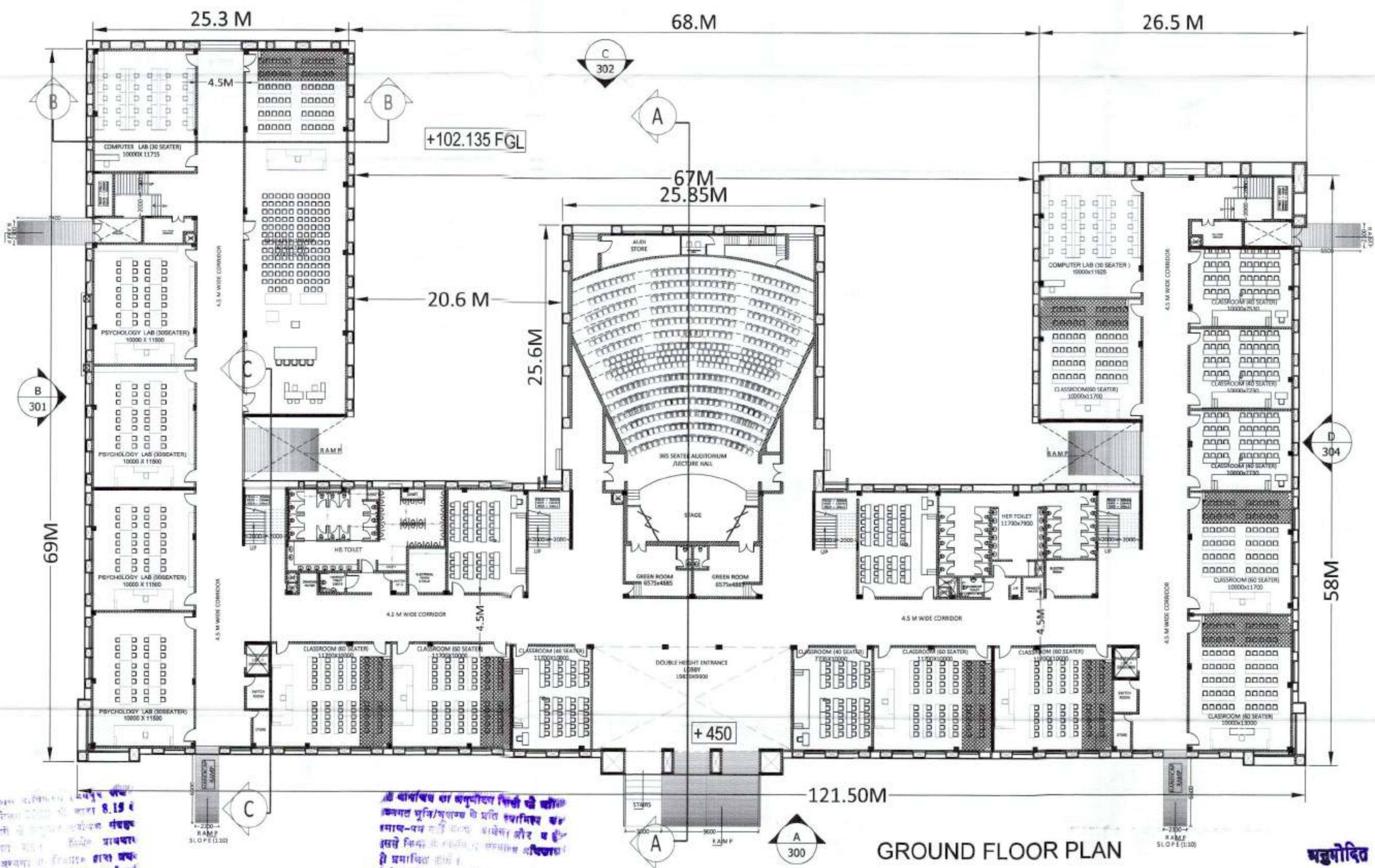

GROUND FLOOR PLAN

सहयोगित

Handwritten notes in Hindi regarding structural and construction details.

Handwritten notes in Hindi regarding structural and construction details.

Handwritten notes in Hindi regarding structural and construction details.

Handwritten notes in Hindi regarding structural and construction details.

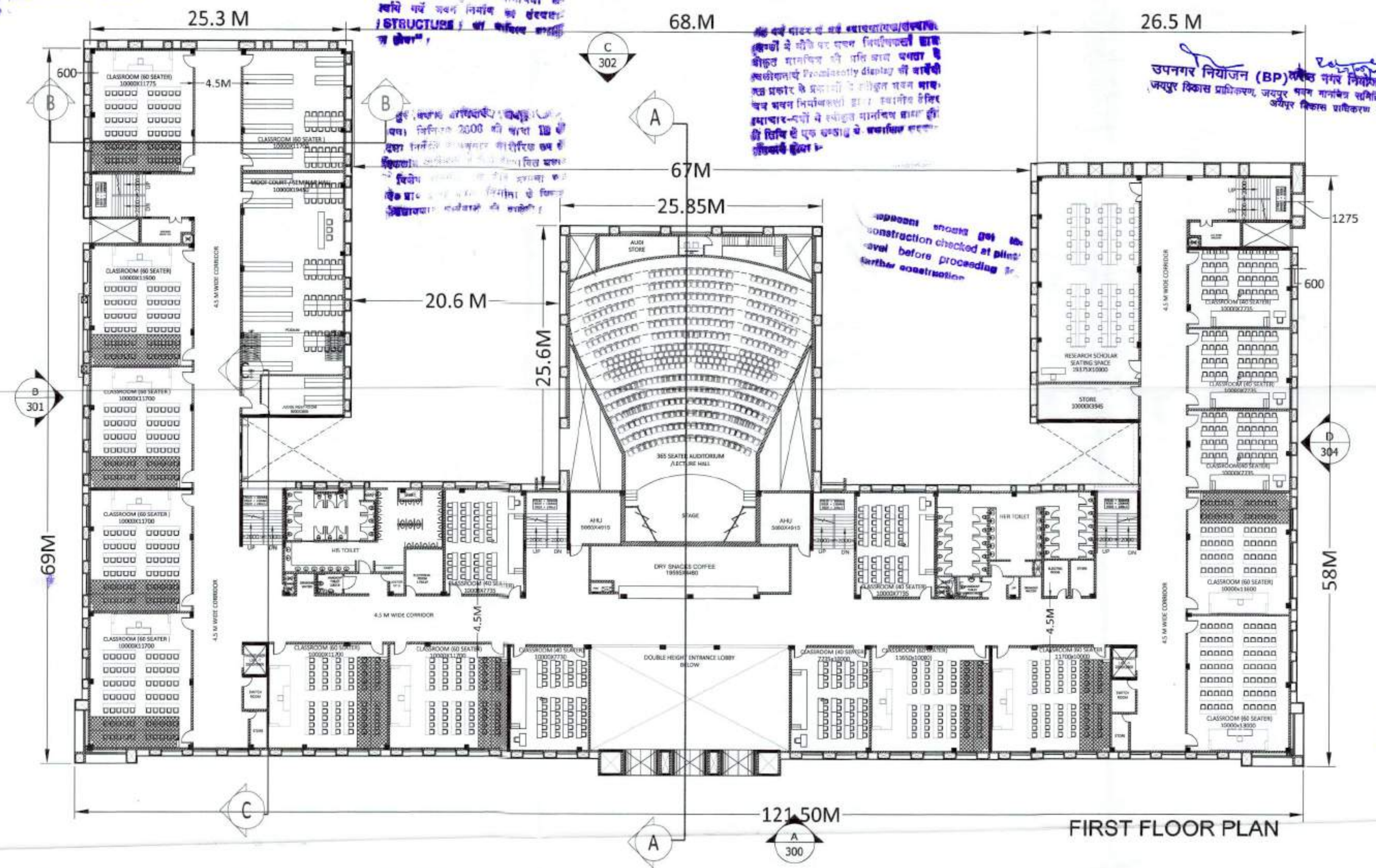

FIRST FLOOR PLAN

Handwritten note: 'approximate amount of construction checked at plot level before proceeding further construction'

PROJECT MANAGEMENT CONSULTANT: DILLIGENT PMC. STRUCTURAL CONSULTANT: TRC Engineering (P) Pvt. Ltd. SERVICES CONSULTANT: TRC Engineering (P) Pvt. Ltd. MEP CONSULTING ENGINEERS: FEP.

PROJECT: PROPOSED 'NEW ACADEMIC BLOCK - 3' MANIPAL UNIVERSITY JAIPUR. KHASRA: 457,468,474,468/1,473,475,542,544. GRAM: DEHMI KALAN, TEHSIL: SANGANEER, JAIPUR, RAJASTHAN.

DRG. TITLE: GROUND FLOOR PLAN & FIRST FLOOR PLAN

Table with 4 columns: REVISION, JOB NO., DRG NO., SCALE. Includes job number 4401 and scale 1:1=300.

SIGNATURE & SEAL OF ARCHITECT: Subhash Chandra Devraht. SIGNATURE & SEAL OF OWNER: [Signature]

Architect Hafeez Contractor. 29 Bank Street, Bombay 400 023. Tel: 2661920.

Handwritten note in Hindi at the bottom right corner.

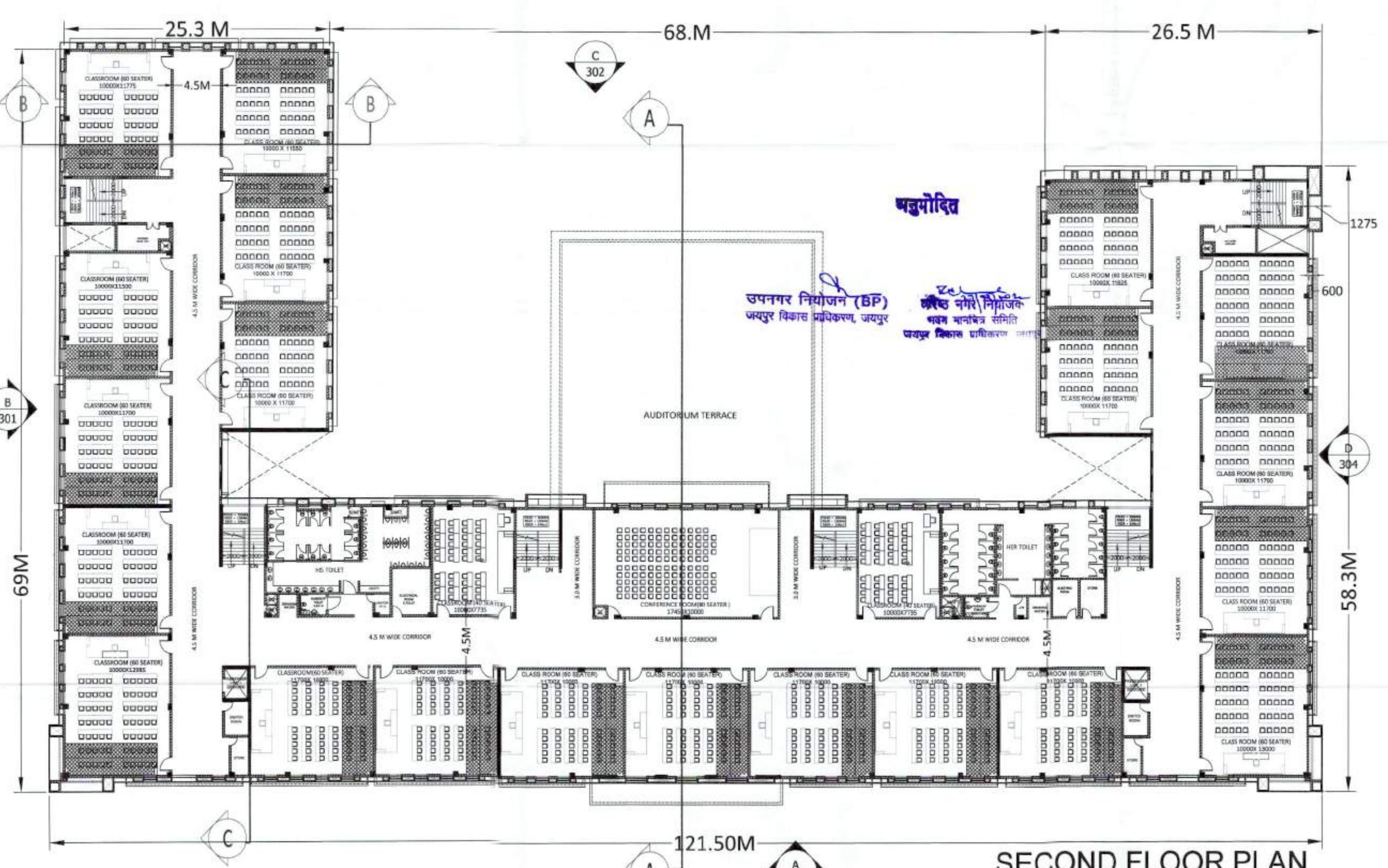

SECOND FLOOR PLAN

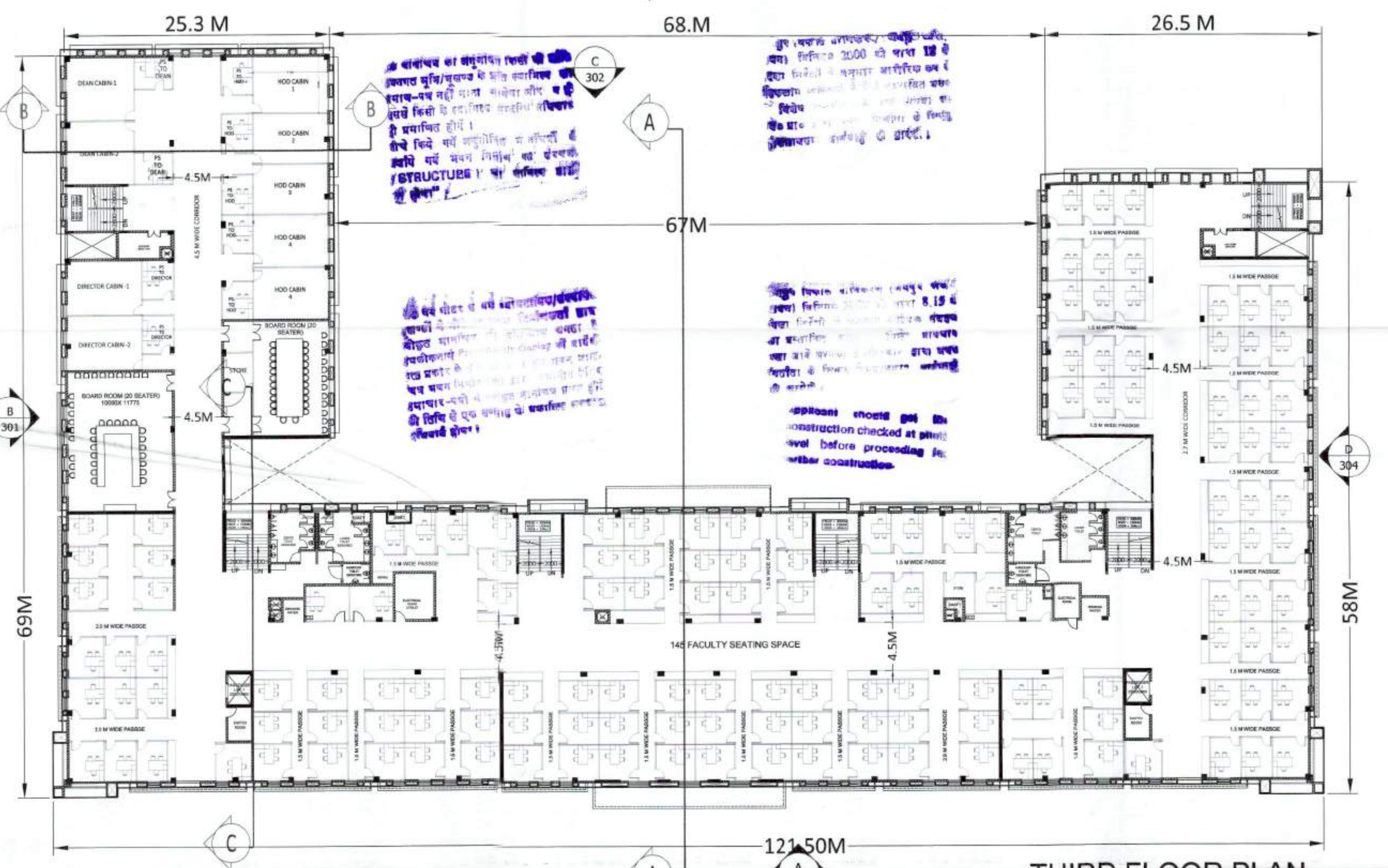

THIRD FLOOR PLAN

DRG NO. **NAB - 3 - (04)**

NOTES
 THE DEVELOPMENT HAS BEEN CONCEIVED, DESIGNED AND CARRIED OUT ON THE BASIS OF THE FOLLOWING PARAMETERS:
 1. ANY DISCREPANCY IN THE DRAWING IS TO BE RESOLVED TO THE FAVOR OF THE ARCHITECT IMMEDIATELY.
 2. ALL DIMENSIONS ARE IN MILLIMETERS UNLESS OTHERWISE SPECIFIED.
 3. ALL DIMENSIONS ARE FROM UNFINISHED TO UNFINISHED SURFACE UNLESS OTHERWISE SPECIFIED.
 4. DRAWING MUST BE SCALED. ONLY WRITTEN DIMENSIONS ARE TO BE FOLLOWED.
 5. DRAWING MUST BE READ IN CONJUNCTION WITH STRUCTURAL DRAWINGS.
 6. THE SIGNATURE OF ALL THE STRUCTURAL MEMBERS TO BE REFERRED FROM DRAWINGS OF STRUCTURAL CONSULTANT.
 7. ALL CENTER LINE DIMENSIONS ARE WITH REFERENCE TO DIM.

REVISIONS	DATE	DESCRIPTION	BY
1	01-03-2013	ISSUED FOR PERMIT	DRG. NO. 301
2			

PROJECT MANAGEMENT CONSULTANT	DILIGENT PMC
STRUCTURAL CONSULTANT	TRC
SERVICES CONSULTANT	TRC Engineering (P) Pvt. Ltd.
MEP CONSULTING ENGINEERS	TRC

PROJECT: **PROPOSED 'NEW ACADEMIC BLOCK - 3'**
 MANIPAL UNIVERSITY JAIPUR
 KHASRA: 467, 469, 474, 468/1, 473, 475, 542, 544
 GRAM: DEHMI KALAN
 TEHSIL: SANGANEER
 JAIPUR, RAJASTHAN

DRG. TITLE:
SECOND FLOOR PLAN & THIRD FLOOR PLAN

REVISION	JOB NO. 4401	DRG. NO.	NORTH
	SCALE: DATE		
	A1: 1:100		
FILE	DEALT BY:	CHECKED BY:	APPROVED BY:

SIGNATURE & SEAL OF ARCHITECT
 Signature: Hafeez Contractor
 Seal: Hafeez Contractor, 29 Bank Street, Bombay 400 023, Tel: 2661920

SIGNATURE & SEAL OF OWNER
 Signature: Sushant Chandra Devarath
 Seal: Sushant Chandra Devarath, 29 Bank Street, Bombay 400 023, Tel: 2661920

Architect Hafeez Contractor
 29 Bank Street, Bombay 400 023, Tel: 2661920

आवासीय का अनुपात (रफ़्त की गति)
 अनुपात 2000 से 2500 के बीच होना चाहिए।
 अनुपात 2000 से 2500 के बीच होना चाहिए।
 अनुपात 2000 से 2500 के बीच होना चाहिए।

इस सीटिंग में सभी छात्रों/छात्राओं को
 सुविधा मिलनी चाहिए।
 सुविधा मिलनी चाहिए।
 सुविधा मिलनी चाहिए।

इस सीटिंग में सभी छात्रों/छात्राओं को
 सुविधा मिलनी चाहिए।
 सुविधा मिलनी चाहिए।
 सुविधा मिलनी चाहिए।

इस सीटिंग में सभी छात्रों/छात्राओं को
 सुविधा मिलनी चाहिए।
 सुविधा मिलनी चाहिए।
 सुविधा मिलनी चाहिए।

महान मानवीय धर्म (मि.ने.) की 254...
 के तहत 25/11/2013 को जारी किया गया।
 स.न./दिनांक (मि.ने.)- 25.11.2013
 25/11/2013 को जारी किया गया।



भारत सरकार
जल शक्ति मंत्रालय
जल संसाधन, नदी विकास
और गंगा संरक्षण विभाग
केन्द्रीय भूमि जल प्राधिकरण
Government of India
Ministry of Jal Shakti
Department of Water Resources,
River Development & Ganga Rejuvenation
Central Ground Water Authority

(भूजल निकासी हेतु अनापत्ति प्रमाण पत्र)
NO OBJECTION CERTIFICATE (NOC) FOR GROUND WATER ABSTRACTION

Project Name:	Academic Block Manipal University Jaipur		
Project Address:	Khasra No 416, 417, 452, 453, 461 And 462, Village Dehmi Kalan, Tehsil Sanganer Jaipur Ajmer Expressway		
Town:	Bagru	Block:	Sanganer
District:	Jaipur	State:	Rajasthan
Pin Code:			
Communication Address:	M/s Manipal University Jaipur, Village Dehmi Kalan, Near Jaipur - Ajmer Road, Sanganer, Jaipur, Rajasthan - 303007		
Address of CGWB Regional Office :	Central Ground Water Board Western Region, 6-a, Jhalana Doongri, Jaipur, Rajasthan - 302004		

1. NOC No.:	CGWA/NOC/INF/REN/1/2024/9102	2. Date of Issuance	14/02/2024										
3. Application No.:	21-4/3271/RJ/INF/2017	4. Category: (GWRE 2023)	Over Exploited										
5. Project Status:	Existing Ground Water	6. NOC Type:	Renewal										
7. Valid from:	09/05/2023	8. Valid up to:	08/05/2025										
9. Ground Water Abstraction Permitted:													
Fresh Water		Saline Water		Dewatering		Total							
m ³ /day	m ³ /year	m ³ /day	m ³ /year	m ³ /day	m ³ /year	m ³ /day	m ³ /year						
100.00	30000.00												
10. Details of ground water abstraction /Dewatering structures													
Total Existing No.:5							Total Proposed No.:0						
	DW	DCB	BW	TW	MP	MPu	DW	DCB	BW	TW	MP	MPu	
Abstraction Structure*	0	0	5	0	0	0	0	0	0	0	0	0	
*DW- Dug Well; DCB-Dug-cum-Bore Well; BW-Bore Well; TW-Tube Well; MP-Mine Pit;MPu-Mine Pumps													
11. Ground Water Abstraction/Restoration Charges paid (Rs.):								284409.00					
12. Environment Compensation (if applicable) paid (Rs.):								700274.00					
13. Number of Piezometers(Observation wells) to be constructed/ monitored & Monitoring mechanism.	No. of Piezometers						Monitoring Mechanism						
							Manual	DWLR**	DWLR With Telemetry				
**DWLR - Digital Water Level Recorder	1						0	1	0				

(Compliance Conditions given overleaf)

This is an auto generated document & need not to be signed.

18/11, जामनगर हाउस, मानसिंह रोड, नई दिल्ली - 110011 / 18/11, Jamnagar House, Mansingh Road, New Delhi-110011
Phone: (011) 23383561 Fax: 23382051, 23386743
Website: cgwa-noc.gov.in

पानी बचाये - जीवन बचाये
SAVE WATER - SAVE LIFE

Validity of this NOC shall be subject to compliance of the following conditions:

Mandatory conditions:

- 1) Installation of tamper proof digital water flow meter with telemetry on all the abstraction structure(s) shall be mandatory for all users seeking No Objection Certificate and intimation regarding their installation shall be communicated to the CGWA within 30 days of grant of No Objection Certificate.
- 2) Proponents shall mandatorily get water flow meter calibrated from an authorized agency once in a year.
- 3) Construction of purpose-built observation wells (piezometers) for ground water level monitoring shall be mandatory as per Section 14 of Guidelines. Water level data shall be made available to CGWA through web portal. Detailed guidelines for construction of piezometers are given in Annexure-II of the guidelines.
- 4) Proponents shall monitor quality of ground water from the abstraction structure(s) once in a year. Water samples from bore wells/ tube wells / dug wells shall be collected during April/May every year and analysed in NABL accredited laboratories for basic parameters (cations and anions), heavy metals, pesticides/ organic compounds etc. Water quality data shall be made available to CGWA through the web portal.
- 5) In case of mining projects, additional key wells shall be established in consultation with the Regional Director, CGWB for ground water level monitoring four (4) times a year (January, May, August and November) in core as well as buffer zones of the mine.
- 6) In case of mining project the firm shall submit water quality report of mine discharge/ seepage from Govt. approved/ NABL accredited lab.
- 7) The firm shall report compliance of the NOC conditions online in the website (www.cgwa-noc.gov.in) within one year from the date of issue of this NOC.
- 8) Industries abstracting ground water in excess of 100 m³/d shall undertake annual water audit through certified auditors and submit audit reports within three months of completion of the same to CGWA. All such industries shall be required to reduce their ground water use by at least 20% over the next three years through appropriate means.
- 9) Application for renewal can be submitted online from 90 days before the expiry of NOC. Ground water withdrawal, if any, after expiry of NOC shall be illegal & liable for legal action as per provisions of Environment (Protection) Act, 1986.
- 10) This NOC is subject to prevailing Central/State Government rules/laws/norms or Court orders related to construction of tube well/ground water abstraction structure / recharge or conservation structure/discharge of effluents or any such matter as applicable.

General conditions:

- 11) No additional ground water abstraction and/or de-watering structures shall be constructed for this purpose without prior approval of the Central Ground Water Authority (CGWA).
- 12) The proponent shall seek prior permission from CGWA for any increase in quantum of groundwater abstraction (more than that permitted in NOC for specific period).
- 13) Proponents shall install roof top rain water harvesting in the premise as per the existing building bye laws in the premise.
- 14) The project proponent shall take all necessary measures to prevent contamination of ground water in the premises failing which the firm shall be responsible for any consequences arising thereupon.
- 15) In case of industries that are likely to contaminate the ground water, no recharge measures shall be taken up by the firm inside the plant premises. The runoff generated from the rooftop shall be stored and put to beneficial use by the firm.
- 16) Wherever feasible, requirement of water for greenbelt (horticulture) shall be met from recycled / treated waste water.
- 17) Wherever the NOC is for abstraction of saline water and the existing wells (s) is /are yielding fresh water, the same shall be sealed and new tubewell(s) tapping saline water zone shall be constructed within 3 months of the issuance of NOC. The firm shall also ensure safe disposal of saline residue, if any.
- 18) Unexpected variations in inflow of ground water into the mine pit, if any, shall be reported to the concerned Regional Director, Central Ground Water Board.
- 19) In case of violation of any NOC conditions, the applicant shall be liable to pay the penalties as per Section 16 of Guidelines.
- 20) This NOC does not absolve the proponents of their obligation / requirement to obtain other statutory and administrative clearances from appropriate authorities.
- 21) The issue of this NOC does not imply that other statutory / administrative clearances shall be granted to the project by the concerned authorities. Such authorities would consider the project on merits and take decisions independently of the NOC.
- 22) In case of change of ownership, new owner of the industry will have to apply for incorporation of necessary changes in the No Objection Certificate with documentary proof within 60 days of taking over possession of the premises.
- 23) This NOC is being issued without any prejudice to the directions of the Hon'ble NGT/court orders in cases related to ground water or any other related matters.
- 24) Proponents, who have installed/constructed artificial recharge structures in compliance of the NOC granted to them previously and have availed rebate of upto 50% (fifty percent) in the ground water abstraction charges/ground water restoration charges, shall continue to regularly maintain artificial recharge structures.
- 25) Industries which are likely to cause ground water pollution e.g. Tanning, Slaughter Houses, Dye, Chemical/ Petrochemical, Coal washeries, pharmaceutical, other hazardous units etc. (as per CPCE list) need to undertake necessary well head protection measures to ensure prevention of ground water pollution as per Annexure III of the guidelines.
- 26) In case of new infrastructure projects having ground water abstraction of more than 20 m³/day, the firm/entity shall ensure implementation of dual water supply system in the projects.
- 27) In case of infrastructure projects, paved/parking area must be covered with interlocking/perforated tiles or other suitable measures to ensure groundwater infiltration/harvesting.
- 28) In case of coal and other base metal mining projects, the project proponent shall use the advance dewatering technology (by construction of series of dewatering abstraction structures) to avoid contamination of surface water.
- 29) The NOC issued is conditional subject to the conditions mentioned in the Public notice dated 27.01.2021 failing which penalty/EC/cancellation of NOC shall be imposed as the case may be.
- 30) This NOC is issued subject to the clearance of Expert Appraisal Committee (EAC) (if applicable).
- 31) In the self-compliance report, the PP shall submit details of Drilling Agency/ Agencies, which has/ have constructed BW(s)/ TW(s) along with undertaking to the effect that all necessary measures have been taken as per directions of Hon'ble Supreme Court provided in Annexure-VII of guidelines dated 24.09.2020 in respect of abandoned/ failed BW(s)/ TW(s)/Piezometer(s), if any. The PP is advised to engage registered drilling agency/ agencies. In the event of any mishap/ unfortunate incident due to negligence in taking measures for prevention of accident due to falling in Bore Well, both PP and concerned drilling agency shall jointly be held responsible and penal action as per extant Government rules shall be taken.

(Non-compliance of the conditions mentioned above is likely to result in the cancellation of NOC and legal action against the proponent.)

CENTRAL GROUND WATER AUTHORITY
Department of Water Resources, River Development and Ganga Rejuvenation
Ministry of Jal Shakti, Govt. of India

18/11, जामनगर हाउस, मानसिंह रोड, नई दिल्ली - 110011 / 18/11, Jamnagar House, Mansingh Road, New Delhi-110011

Phone: (011) 23383561 Fax: 23382051, 23386743

Website: cgwa-noc.gov.in

पानी बचाये - जीवन बचाये
SAVE WATER - SAVE LIFE

	Manipal University Jaipur - Academic Block 3	
	Project Name – Manipal University Jaipur - Academic Block 3	
	Project Code – 22GR0118	
	Address: - Jaipur, Rajasthan	
	Site area: - 14,809 m² (As per online panel)	
	Total built-up – 21,525 m² (As per online panel)	
	No. of buildings – 1 Building (Institutional)	
<i>Compiled by GRIHA Council</i>		
General Comments:		
Criterion	Appraisal	Feedback Comments
Criterion 4	Air and Soil Pollution Control	
	<p>Partly Mandatory – 4.2.1 Adopt at least six measures to minimize air and soil pollution during construction, with the first three strategies being mandatory.</p> <ul style="list-style-type: none"> • Provide 3m high continuous barricading along the site boundary/virtual boundary. • Provide wheel washing facility/gravel bed at all vehicular entrances and exits of the site. • Ensure DG sets have an exhaust with stack height of at least 2m from the top of the generator with a cowl. • Ensure DGs are in compliance with CPCB norms. 	<p>4.2.1 Submittal has been provided consisting of the following documents- - Narrative, site visit reports, and compliance report have been submitted stating that the following strategies were adopted in the project to minimize air and soil pollution during construction:</p> <ul style="list-style-type: none"> • Provision of 3 m high continuous barricading is provided along the site boundary. • Wheel washing facility is provided at the vehicular entry and exit of the site. • DG sets were not used on site. The demand is being met through campus level facility. Hence this measure is not applicable for the project.

	<ul style="list-style-type: none"> • Implement a spill prevention plan for storage of diesel, admixtures, curing compounds, bitumen, and other hazardous materials. • Ensure that fine aggregate, excavated earth, and other construction materials with a tendency to get airborne are covered or are sprinkled regularly with non-potable water. • Ensure sprinkling of water on unpaved pathways on the site with non-potable water. • Limit the speed of vehicular movement on-site to 10km/hr. • Ensure that vehicles carrying waste materials out of the site are covered 	<ul style="list-style-type: none"> • Hazardous materials were stored in an enclosed space on an impervious surface. • Fine aggregate, excavated earth, and other construction materials with a tendency to get airborne were covered. • Speed limit on site has been restricted to 10km/hr. Signages for the same were displayed onsite. • Vehicles carrying waste materials out of the site were covered. <p>- Photographs of the measures implemented onsite have been submitted.</p> <p>- Site management plan has been submitted in Criteria 6. However, location of wheel washing facility, Diesel storage and storage of fine aggregate, excavated earth, and other construction materials were not highlighted in the same.</p> <p>Required:</p> <ul style="list-style-type: none"> • Submit site management plan (during construction stage) highlighting location of DG, wheel washing facility, Diesel storage, soil erosion channels, sedimentation tank, storage of fine aggregate, excavated earth, and other construction materials.
	<p>4.2.2 Ensure that the soil erosion channels are constructed, and they are connected to a sedimentation tank in order to reduce movement of soil outside the site throughout the construction phase of the project.</p>	<p>4.2.2 Submittal has been provided consisting of the following documents-</p> <p>- As per the site visit reports, and compliance report, soil erosion channels and sedimentation tanks were provided on site. Photographs of the soil erosion channels & sedimentation tank have been submitted in due diligence I & II compliance documents.</p> <p>Site management plan highlighting location of soil erosion channels and sedimentation tanks provided on site has been submitted.</p> <p>The documentation is complete.</p>
<p>Criterion 5</p>	<p>Topsoil Preservation</p>	

	<p>5.1.1 Ensure that topsoil from disturbed areas on the site is preserved, stabilized, and its fertility is maintained throughout the construction period. Additionally, ensure that 100% of the soil requirement for landscaping including roof garden(s) is met through this preserved soil.</p>	<p>5.1.1 Submittal has been provided consisting of the following documents-</p> <ul style="list-style-type: none"> - Narrative has been submitted stating the topsoil from the disturbed areas on-site is preserved and 100% of the soil requirement for project landscaping is met through this preserved soil. - Images of topsoil preservation have been submitted. - Calculation have been submitted in the online panel indicating the following: <ul style="list-style-type: none"> ▪ Total topsoil preserved – 1,135.6 m³. ▪ Soil requirement for project landscaping – 572.6 m³. ▪ Total area from where topsoil was excavated – 5,678 m². However, the same has not been highlighted in the site management plan. ▪ Percentage of fertile soil used in landscape – 198.32 %. - Soil fertility test report of the project from state level soil testing laboratory has been submitted. - A site management plan highlighting location of topsoil preservation area has been submitted. However, location of topsoil excavation area has not been highlighted. <p>Required:</p> <ul style="list-style-type: none"> • Submit a site management plan in .dwg format highlighting location of topsoil excavation/disturbed area for the project.
--	--	--

Criterion 6

<p>Construction Management Practices</p>	
<p>6.1.1 Adopt construction management practices (e.g., stacking and storage of construction materials at different stages of construction) and ensure safe disposal of waste generated during construction.</p>	<p>6.1.1 Submittal has been provided consisting of the following documents-</p> <ul style="list-style-type: none"> - Narrative has been submitted stating that construction management practices such as stacking and storage of construction materials at different stages of construction were adopted on site and all the construction waste is safely disposed of through agreements with waste haulers and recyclers. - As per the site visit reports compiled by GRIHA officials, staging was adopted on site.

		<ul style="list-style-type: none"> - Photographs of construction management practices adopted on-site have been submitted. - Site management plan has been submitted highlighting the locations of different material & waste storage. - Log sheets of total quantities of waste generated on site as steel, wood, packaging materials, cement bags etc. have not been submitted. - Challans/Sell invoices reflecting full quantities of waste such as MS scrap, wood, packaging materials, cement bags etc. sold to recyclers have not been submitted. <p>Required:</p> <ul style="list-style-type: none"> • Submit detailed narrative about quantum of waste generated during construction, storage facilities for inert and hazardous wastes and measures employed for its safe disposal/recycling. • Submit Log sheets of total quantities of waste generated on site as steel, wood, packaging materials, cement bags etc. • Submit challans reflecting full quantities of waste such as steel, wood, packaging materials, cement bags etc. sold to recyclers.
	<p>6.1.2 Adopt at least two strategies from the list, as given below, to minimize water consumption during construction, with the first strategy being mandatory.</p> <p>Mandatory –</p> <ul style="list-style-type: none"> ○ Use gunny bags, ponding technique, or curing compound. ○ Meter and monitor the consumption of water during construction. ○ Use water-reducing admixtures in concrete mix. ○ Use treated wastewater and/or captured storm water 	<p>6.1.2 Submittal has been provided consisting of the following documents-</p> <ul style="list-style-type: none"> - As per the site visit reports compiled by GRIHA officials, the following measures were adopted in the project: <ul style="list-style-type: none"> • Use of gunny bags and ponding technique for curing of columns and slabs, respectively. Photographs of the same has been submitted. • Use of water reducing admixtures (SAINT GOBAIN CHRYSO Delta G6541C-ADS) in concrete. Batch mix report of M25, M30 & M40 concrete grades were shared during the visit indicating the use of admixture was submitted. However, purchase order and technical specification sheet of the admixture was not submitted which confirms water reducing properties. Further, design mix reports for M25, M30 & M40 concrete grades have not been submitted.

		<p>Required:</p> <ul style="list-style-type: none"> • Submit purchase order and technical specification sheet of SAINT GOBAIN CHRYSO Delta G6541C-ADS confirming it's water reducing properties. • Submit design mix reports for M25, M30 & m40 concrete grades highlighting the make and name of admixtures used in the concrete grades.
<p>Criterion 23</p>	<p>Safety and Sanitation for Construction Workers</p> <p>Mandatory – 23.1.1 Ensure compliance with the requirements of NBC 2016 for all the following:</p> <p>Part 1: Provision of necessary safety equipment and safety measures for construction workers.</p> <p>Part 2: Provision of clean drinking water, hygienic working and living conditions, and sanitation facilities for the workers.</p> <p>Part 3: Provision of crèche facility for children of construction workers in case their families are allowed to work/live at the construction site.</p> <p><i>Applicability check: If there are only male workers employed and residing on site, the project is exempt from Appraisal 23.1.1 - Part 3</i></p>	<p>23.1.1 Submittal has been provided consisting of the following documents-</p> <p>- Narrative, drinking water test report and date stamped photographs have been submitted indicating the following:</p> <ul style="list-style-type: none"> • Construction workers were wearing hard-hats and safety boots. • Temporary railings were provided on the staircases. • Safety nets were provided in accident-prone areas as well as adjacent to the scaffolding. • Safety equipment such as gloves and safety harnesses were provided to workers depending on the nature of their work. • Safety signage in local languages were displayed at multiple locations on site. • First aid facility was provided on site. • Drinking water facility was provided on site and in the labour accommodation area. Drinking water test report was submitted by the project team along with the compliance report. • Clean and hygienic toilets were provided for the construction workers on site and in the labour accommodation area. • Clean and hygienic bathing area was provided at the labour accommodation area. • Clean and hygienic labour accommodation was provided for the construction workers. The hutments were made of GI sheets and sharp edges of the same were secured.

		<ul style="list-style-type: none"> • The hutments had provision for daylight and ventilation. General cleanliness was maintained in the area surrounding the labour accommodation. • Dustbins were provided in the labour accommodation area. • Creche facility was provided near the labour accommodation. <p>Site visit reports confirm the same.</p> <p>The documentation is complete.</p>
	<p>23.1.2 Adopt one alternative out of the following for the construction workers on-site.</p> <p>Alternative 1: Provide a grocery store/canteen within the site premises and/or labour accommodation.</p> <p>Alternative 2: Organize at least two events during the entire construction phase to create environmental awareness among the construction workers.</p>	<p>23.1.2 Submittal has been provided consisting of the following documents-</p> <p>- As per the due diligence II site visit, two environmental awareness programs were conducted for the construction workers during the construction phase. The photographs have been submitted highlighting awareness programs have been conducted among the construction workers.</p> <p>The documentation is complete.</p>
<p>Criterion 26</p>	<p>Positive Social Impact</p>	
	<p>Mandatory –</p> <p>26.1.4 Ensure that tobacco smoking is prohibited on-site during the entire construction phase.</p>	<p>26.1.4 Submittal has been provided consisting of the following documents-</p> <p>- Photographs have been submitted indicating that tobacco is prohibited on site and ‘no smoking’ signages were displayed in multiple locations. Site visit report compiled by GRIHA Council officials and the compliance report submitted by the project team confirms the same. A non-smoking policy document highlighting prohibition of tobacco smoking within the site premises during the construction phase has been submitted.</p> <p>The documentation is complete.</p>